



*The* **Big** *at Express*  
*Ranches*  
**Event**

**FRIDAY, AUGUST 18, 2017**

1:00 p.m. 231 Fall-Calving Females

6:00 p.m. Pre-sale Gala/Country Music Spectacular  
at the home of Bob Funk

**SATURDAY, AUGUST 19, 2017**

7:30 a.m. Coffee, Juice and Pastries

11:00 a.m. Big Event Sale - Live at Express Ranches 300+ Lots

**BID LIVE BOTH DAYS:** [www.superiorlive.com](http://www.superiorlive.com) & [www.liveauctions.tv](http://www.liveauctions.tv)

**SALE-DAY SUPPLEMENT**

# Welcome to Express Ranches & the Big Event Angus Sale

UPDATED 09.17.17 - a.m.

LOT	UPDATED INFORMATION	LOT	UPDATED INFORMATION
1	Bred to EXAR Exchange Rate 6256B 6/30/2017. Checked Safe	317	Sells Open.
17B	Bred to EXAR Exchange Rate 6256B on 5/31/2017. Checked Safe.	330	Sells Open.
73	Flushed 2 times for a total of 22 high quality embryos.	357	Bred to Curtin Resonate 5051 on 6/20/2017. Checked Safe.
93	Due after 09/01/2017 to EXAR Emblazon 3356B.	574	Flushed 4 times for a total of 30 high-quality embryos.
222	Bred to EXAR Exchange Rate 6256B on 6/01/2017. Checked Safe.	<b>OUT OF SALE</b>	
240	Bred to EXAR EZ Choice 6634B on 7/2/2017. Checked Safe.	9B, 58, 71, 85, 215, 226, 323A, 327, 327A, 510, 539, 576,	
251	Bred to EXAR Exchange Rate 6256B on 5/31/2017. Checked Safe.	583, 611, 616, 663, 677, 699, 712, 718	
307	Sells Open.		
313	Flushed 4 times for a total of 12 high-quality embryos.		

## UPDATED WEANING WEIGHTS

LOT	ADJ. WW	LOT	ADJ. WW	LOT	ADJ. WW	LOT	ADJ. WW	LOT	ADJ. WW	LOT	ADJ. WW
2	713 LBS.	56B	673 LBS.	113	668 LBS.	144	588 LBS.	307A	734 LBS.	334A	741 LBS.
3	672 LBS.	57A	703 LBS.	114	641 LBS.	145	590 LBS.	308A	614 LBS.	335A	731 LBS.
4A	700 LBS.	57B	613 LBS.	115	670 LBS.	146	705 LBS.	309A	718 LBS.	336A	640 LBS.
4B	642 LBS.	59	671 LBS.	116	681 LBS.	147	638 LBS.	310A	781 LBS.	337A	809 LBS.
4C	626 LBS.	60	649 LBS.	121	735 LBS.	148	627 LBS.	311A	764 LBS.	338A	719 LBS.
5	696 LBS.	61	700 LBS.	122	642 LBS.	149	716 LBS.	312A	693 LBS.	339A	797 LBS.
6	655 LBS.	62	690 LBS.	123	664 LBS.	150	627 LBS.	313A	691 LBS.	340A	787 LBS.
8A	683 LBS.	63A	702 LBS.	124	630 LBS.	151	637 LBS.	314A	767 LBS.	341A	637 LBS.
8B	692 LBS.	63B	636 LBS.	126	782 LBS.	152	607 LBS.	315A	790 LBS.	342A	653 LBS.
11	641 LBS.	64	662 LBS.	128	716 LBS.	205	647 LBS.	316A	756 LBS.	343A	607 LBS.
42	736 LBS.	65	674 LBS.	129	727 LBS.	206	702 LBS.	317A	734 LBS.	344A	696 LBS.
43	644 LBS.	66	613 LBS.	130	606 LBS.	207	555 LBS.	318A	707 LBS.	345A	703 LBS.
44	777 LBS.	100	645 LBS.	131	671 LBS.	208	648 LBS.	319A	807 LBS.	346A	732 LBS.
45	640 LBS.	101	656 LBS.	132	612 LBS.	209	767 LBS.	320A	749 LBS.	347A	689 LBS.
46	614 LBS.	102	656 LBS.	133	617 LBS.	210A	722 LBS.	321A	765 LBS.	348A	628 LBS.
47	750 LBS.	103	558 LBS.	134	714 LBS.	210B	641 LBS.	322A	795 LBS.	349A	711 LBS.
48	671 LBS.	104	617 LBS.	135	677 LBS.	212	701 LBS.	324A	783 LBS.	350A	722 LBS.
49	617 LBS.	105	638 LBS.	136	581 LBS.	213	718 LBS.	325A	735 LBS.	351A	663 LBS.
50	628 LBS.	106	755 LBS.	137	604 LBS.	214	575 LBS.	326A	790 LBS.	352A	721 LBS.
51	678 LBS.	107	673 LBS.	138	597 LBS.	301A	820 LBS.	328A	737 LBS.	353A	605 LBS.
52	681 LBS.	108	634 LBS.	139	614 LBS.	302A	706 LBS.	329A	771 LBS.	354A	606 LBS.
53	773 LBS.	109	617 LBS.	140	662 LBS.	303A	784 LBS.	330A	674 LBS.	355A	660 LBS.
55A	730 LBS.	110	664 LBS.	141	587 LBS.	304A	725 LBS.	331A	610 LBS.	356A	699 LBS.
55B	715 LBS.	111	557 LBS.	142	602 LBS.	305A	687 LBS.	332A	684 LBS.	357A	641 LBS.
56A	646 LBS.	112	669 LBS.	143	557 LBS.	306A	715 LBS.	333A	741 LBS.	358A	627 LBS.

## — UPDATED CALVING INFORMATION —

LOT	TATTOO	REG#	BIRTH DATE	SEX	SIRE'S NAME	ACT. BW	CED	BW	WW	MILK	YW	CW	MARB	REA	\$B
17	7267	18851920	8/9/17	C	Quaker Hill Rampage 0A36	75	11	1.4	70	25	120	53	0.45	1.04	151.76
18	7265	18848975	8/5/17	C	EXAR Stud 4658B	65	9	1.5	75	22	135	67	0.86	1.01	188.84
67	7236	18845761	7/17/17	C	EXAR Stud 4658B	76	9	1.2	63	25	117	53	0.85	0.60	168.90
69	7300B	18849436	8/4/17	B	EXAR Stud 4658B	74	3	2.4	74	19	128	64	0.93	0.70	183.86
75	7299B	18851655	8/3/17	B	G A R Sure Fire	67	17	-1.3	59	29	112	47	1.08	0.75	156.25
76	7264	18848974	8/2/17	C	EXAR Stud 4658B	59	12	0.5	60	21	110	49	0.80	0.62	149.31
78	7237	18849944	7/18/17	C	EXAR Spread 5767B	68	13	-0.6	59	29	110	46	0.68	0.83	148.66
81	7250	18845768	7/30/17	C	EXAR Stud 4658B	61	8	1.7	59	20	111	53	0.93	0.70	170.28
82	7266B	18845777	7/17/17	B	EXAR Stud 4658B	75	9	1.5	63	20	116	51	0.91	0.74	162.15
83	7272B	18848687	7/26/17	B	EXAR Stud 4658B	67	7	0.7	66	23	112	53	0.95	0.64	170.30
84	7903B	18851346	8/8/17	B	G A R Sure Fire	76	14	0.1	57	23	113	48	1.19	0.57	151.93
86	7270B	18845781	7/22/17	B	EXAR Stud 4658B	79	7	2.1	62	27	112	54	1.09	0.88	182.85

— **UPDATED CALVING INFORMATION** —

LOT	TATTOO	REG#	BIRTH DATE	SEX	SIRE'S NAME	ACT. BW	GED	BW	WW	MILK	YW	CW	MARB	REA	\$B
87	7245	18851648	7/23/17	C	G A R Sure Fire	64	12	0.6	64	18	113	42	1.21	0.81	157.19
89	7247	18845766	7/23/17	C	EXAR Stud 4658B	67	7	1.3	70	29	128	56	0.90	0.73	167.26
90	7267B	18845778	7/20/17	B	EXAR Stud 4658B	68	9	1.4	72	24	127	57	0.92	0.80	174.13
92	7246	18851654	7/26/17	C	G A R Sure Fire	60	9	1.6	67	27	115	50	1.20	0.57	153.91
117	7266	18848976	7/31/17	C	3F Epic 4631	68	8	1.3	74	21	130	51	0.80	0.45	155.92
<i>(Lot 117 - grafted single birth calf from Lot 85)</i>															
118	7273	18851343	8/11/17	C	PVF Insight 0129	87	4	3.0	60	22	100	42	0.06	0.97	120.78
120	7292B	18848977	7/30/17	B	EXAR Blue Chip 1877B	65	4	3.5	61	18	99	28	0.41	0.18	84.97
501	7297B	18851498	8/7/17	B	Quaker Hill Rampage 0A36	67	10	1.3	79	24	143	65	0.64	1.15	185.42
502	7907B	18851350	8/10/17	B	Quaker Hill Rampage 0A36	75	5	2.8	81	20	139	70	0.68	1.14	190.54
503	7181	18845745	8/2/17	C	EXAR Stud 4658B	60	11	0.7	58	24	102	48	0.84	0.65	149.81
504	7186B	18845750	7/21/17	B	EXAR Stud 4658B	77	11	0.2	60	23	106	45	0.96	0.75	153.24
505	7200B	18851167	7/21/17	B	EXAR Stud 4658B	75	13	-0.6	54	24	101	43	0.94	0.73	151.89
507	7166	18845731	7/17/17	C	EXAR Stud 4658B	68	13	0.1	60	26	105	42	0.83	0.68	146.43
511	7185	18851304	8/12/17	C	3F Epic 4631	71	14	0.2	70	29	133	56	0.59	0.63	161.01
512	7173	18845738	7/23/17	C	EXAR Stud 4658B	72	5	2.1	72	31	131	66	0.87	0.80	180.00
513	7164	18845729	7/15/17	C	EXAR Stud 4658B	78	10	0.3	58	31	102	46	0.74	0.81	150.15
514	7198B	18849444	8/6/17	B	EXAR Prophetic 5732B	69	8	1.8	62	31	108	49	1.00	0.76	147.39
515	7184	18848968	8/9/17	C	EXAR Spread 5767B	65	7	1.5	59	28	102	40	0.86	0.83	148.44
516	7175	18851650	7/24/17	C	G A R Sure Fire	67	9	1.7	64	28	116	50	0.99	0.66	167.57
519	7167	18845732	7/20/17	C	3F Epic 4631	75	12	-0.2	68	26	127	55	0.73	0.62	166.33
520	7183B	18845748	7/17/17	B	3F Epic 4631	76	15	-2.0	63	26	116	48	0.92	0.28	136.51
521	7172	18845737	7/23/17	C	EXAR Rapture 5844B	72	11	0.2	53	27	101	38	0.50	0.66	135.96
524	7197B	18845760	8/4/17	B	EXAR Stud 4658B	73	9	0.6	65	35	114	52	1.30	0.61	159.00
525	7185B	18845749	7/20/17	B	EXAR Resistol 3710B	78	9	1.2	61	22	109	53	0.74	0.86	159.84
527	7238	18845762	7/18/17	C	HA Cowboy Up 5405	65	9	1.1	69	16	127	53	0.45	0.54	158.33
528	7269	18851340	8/10/17	C	HA Cowboy Up 5405	60	10	1.5	70	16	130	51	0.32	0.68	152.75
531	7268B	18845779	7/21/17	B	EXAR Rapture 5844B	70	7	2.1	67	23	122	53	0.79	0.81	166.14
535	7905B	18851348	8/10/17	B	HA Cowboy Up 5405	80	9	1.3	66	22	120	49	0.26	0.88	145.09
544	7259	18848970	8/7/17	C	Quaker Hill Rampage 0A36	72	10	2.4	70	20	132	59	0.65	1.05	164.76
545	7269B	18845780	7/22/17	B	G A R Prophet K243	72	6	2.4	76	31	138	60	0.74	0.91	163.86
547	7263	18849437	8/6/17	C	EXAR Stud 4658B	60	10	0.6	54	25	99	49	0.93	0.53	154.14
550	7277B	18848701	7/28/17	B	EXAR Stud 4658B	82	9	1.2	51	29	100	42	0.91	0.60	142.11
551	7274B	18848709	7/27/17	B	HA Cowboy Up 5405	81	7	1.8	70	16	120	50	0.23	0.47	139.86
552	7272	18852489	8/10/17	C	HA Cowboy Up 5405	58	5	2.1	61	18	106	45	0.31	0.60	138.93
554	7289B	18849336	7/29/17	B	Quaker Hill Rampage 0A36	75	10	1.5	67	22	111	50	0.44	1.05	153.30
557	7274	18851344	8/12/17	C	EXAR Stetson 3704B	68	11	-0.2	55	34	101	35	0.67	0.53	114.87
558	7280B	18850289	7/30/17	B	Quaker Hill Rampage 0A36	86	10	1.9	71	22	117	48	0.68	0.82	154.67
559	7239	18848282	7/16/17	C	EXAR Rapture 5844B	67	9	1.0	61	25	111	45	0.69	0.71	148.26
560	7252	18849338	7/29/17	C	Quaker Hill Rampage 0A36	82	4	3.5	73	22	127	55	0.51	0.92	156.42
562	7253	18845769	7/28/17	C	G A R Prophet K243	68	5	2.2	69	28	120	42	0.89	0.79	140.25
563	7906B	18851349	8/10/17	B	3F Epic 4631	76	10	-0.1	59	20	103	35	0.84	0.48	122.82
567	7265B	18845776	7/16/17	B	HA Cowboy Up 5405	83	7	2.5	69	21	119	49	0.38	0.69	151.15
569	7275	18851345	8/14/17	C	EXAR Rapture 5844B	67	7	1.5	66	27	119	52	0.74	0.82	162.58
579	7190B	18845754	7/28/17	B	EXAR Resistol 3710B	69	10	1.9	69	23	125	62	0.37	0.90	160.43
580	7186	18852594	8/15/17	C	EXAR Stetson 3704B	70	7	1.2	63	29	112	42	0.48	0.92	130.02
581	7183	18848967	8/7/17	C	3F Epic 4631	65	11	0.2	67	25	121	48	0.45	0.63	141.79
582	7171	18845736	7/22/17	C	EXAR Stetson 3704B	77	9	1.9	61	27	107	38	0.52	0.71	126.43

— **UPDATED CALVING INFORMATION** —

LOT	TATTOO	REG#	BIRTH DATE	SEX	SIRE'S NAME	ACT. BW	CED	BW	WW	MILK	YW	CW	MARB	REA	\$B
584	7174	18845739	7/23/17	C	3F Epic 4631	67	10	0.6	67	22	118	45	0.31	0.51	122.96
585	7179	18845743	8/1/17	C	3F Epic 4631	67	4	2.6	80	22	139	53	0.54	0.39	148.80
587	7271	18851342	8/10/17	C	EXAR Stetson 3704B	68	11	1.2	57	25	101	29	0.65	0.44	112.26
588	7279B	18845786	8/1/17	B	EXAR Blue Chip 1877B	89	2	3.7	59	26	92	27	0.33	0.34	90.85
589	7910B	18851353	8/10/17	B	EXAR Stud 4658B	91	6	2.1	57	21	101	44	0.84	0.39	141.65
590	7271B	18845782	7/21/17	B	EXAR Blue Chip 1877B	83	6	2.6	61	23	99	36	0.59	0.48	114.26
591	7912B	18851355	8/11/17	B	HA Cowboy Up 5405	70	9	1.8	66	9	114	41	0.44	0.53	136.36
594	7263B	18845774	7/14/17	B	HA Cowboy Up 5405	78	9	1.6	76	13	137	56	0.41	0.64	163.41
596	7294B	18848979	8/6/17	B	3F Epic 4631	74	9	0.3	66	20	119	45	0.74	0.52	144.02
597	7199B	18851656	8/6/17	B	G A R Sure Fire	59	10	1.2	59	23	109	46	1.23	0.86	159.32
600	7275B	18845784	7/28/17	B	G A R Prophet K243	86	10	1.3	68	34	121	46	0.95	0.78	152.21
601	7914B	18851356	8/14/17	B	HA Cowboy Up 5405	82	8	1.3	65	16	124	47	0.42	0.51	144.65
603	7243	18848705	7/22/17	C	EXAR Avatar 5516B	67	8	1.7	57	24	102	40	0.56	0.62	136.95
605	7262	18848973	8/6/17	C	EXAR Stetson 3704B	70	9	1.6	68	26	116	38	0.33	0.53	103.40
608	7291B	18845793	8/2/17	B	EXAR Stetson 3704B	70	8	2.1	67	26	119	48	0.63	0.73	142.48
609	7295B	18848980	8/4/17	B	3F Epic 4631	78	10	1.1	76	23	132	60	0.60	0.55	159.02
610	7244	18845765	7/24/17	C	EXAR Rapture 5844B	67	8	1.7	65	24	120	54	0.83	1.11	184.14
615	7909B	18851352	8/10/17	B	HA Cowboy Up 5405	80	7	0.8	64	20	113	47	0.28	0.56	146.81
619	7240	18845763	7/21/17	C	HA Cowboy Up 5405	78	5	2.2	63	13	109	42	0.28	0.52	133.11
620	7264B	18845775	7/15/17	B	G A R Prophet K243	87	3	3.1	75	33	135	57	0.75	0.92	157.96
622	7288B	18845791	7/27/17	B	HA Cowboy Up 5405	72	9	1.3	67	16	123	56	0.14	0.71	154.84
623	7270	18851341	8/9/17	C	HA Cowboy Up 5405	67	8	1.0	62	16	111	42	0.16	0.73	131.68
626	7273B	18845783	7/26/17	B	HA Cowboy Up 5405	75	8	1.4	61	12	115	45	0.17	0.44	140.54
632	7286B	18845789	8/2/17	B	EXAR Stetson 3704B	57	6	2.2	60	23	106	37	0.45	0.48	112.55
634	7293B	18848978	8/6/17	B	EXAR Stetson 3704B	78	10	1.2	55	25	98	30	0.45	0.69	110.79
635	7258	18847474	8/2/17	C	EXAR Stetson 3704B	62	7	1.6	57	26	102	36	0.51	0.57	118.32
636	7255	18845771	7/30/17	C	EXAR Stetson 3704B	61	8	2.2	65	24	113	40	0.67	0.59	131.31
637	7298B	18848981	8/4/17	B	EXAR Stetson 3704B	72	8	0.7	57	25	101	37	0.51	0.66	114.75
639	7195B	18845759	8/2/17	B	EXAR Stetson 3704B	77	10	0.8	58	21	107	37	0.31	0.77	114.28
640	7170	18845735	7/22/17	C	EXAR Stetson 3704B	76	9	1.3	64	29	109	34	0.51	0.64	107.76
641	7168	18845733	7/20/17	C	EXAR Resistol 3710B	75	12	0.4	51	33	94	43	0.73	0.76	132.28
642	7196B	18848969	8/4/17	B	3F Epic 4631	70	N/A	N/A	N/A	N/A	N/A	N/A	N/A	N/A	N/A
643	7187B	18845751	7/22/17	B	EXAR Resistol 3710B	72	12	0.8	57	24	101	38	0.46	0.85	121.22
644	7165	18845730	7/15/17	C	3F Epic 4631	75	14	-0.7	71	24	127	49	0.57	0.40	135.10
645	7193B	18845757	7/31/17	B	3F Epic 4631	75	13	-0.8	63	27	118	38	0.76	0.30	125.32
646	7180	18845744	8/2/17	C	EXAR Spread 5767B	65	11	-0.3	60	25	102	35	0.71	0.64	131.17
647	7169	18845734	7/21/17	C	EXAR Stud 4658B	78	11	-0.3	60	24	109	42	0.85	0.44	144.37
648	7176	18845740	7/26/17	C	EXAR Stud 4658B	53	10	0.2	70	29	130	56	1.06	0.70	170.79
649	7189B	18845753	7/25/17	B	3F Epic 4631	71	12	-0.6	64	24	116	42	0.79	0.41	137.09
650	7191B	18845755	7/30/17	B	3F Epic 4631	71	9	0.7	70	21	131	52	0.56	0.47	147.78
651	7268	18852490	8/9/17	C	Quaker Hill Rampage 0A36	80	7	2.5	65	20	108	46	0.68	0.79	153.64
652	7251	18848708	7/29/17	C	EXAR Rapture 5844B	82	10	1.3	63	32	112	49	0.68	0.80	152.40
653	7296B	18848963	8/4/17	B	Quaker Hill Rampage 0A36	80	8	1.2	61	17	103	35	0.60	0.77	127.25
657	7276B	18848707	7/29/17	B	EXAR Rapture 5844B	91	10	1.1	59	28	106	44	0.61	0.75	147.79
659	7261	18848972	8/7/17	C	EXAR Stetson 3704B	63	9	1.3	61	23	111	42	0.60	0.64	132.38
662	7911B	18851354	8/12/17	B	EXAR Stetson 3704B	82	7	2.4	69	27	120	43	0.43	0.63	125.64
664	7915B	18852596	8/15/17	B	HA Cowboy Up 5405	83	9	1.3	65	19	119	51	0.28	0.59	146.74
674	7248	18848706	7/25/17	C	EXAR Spread 5767B	67	8	1.2	62	20	115	43	0.65	0.78	149.87
679	7241	18845764	7/22/17	C	HA Cowboy Up 5405	68	8	0.3	65	23	112	53	0.42	0.64	155.90

— **UPDATED CALVING INFORMATION** —

LOT	TATTOO	REG#	BIRTH DATE	SEX	SIRE'S NAME	ACT. BW	CED	BW	WW	MILK	YW	CW	MARB	REA	\$B
681	7249	18845767	7/25/17	C	HA Cowboy Up 5405	67	8	1.9	70	26	124	62	0.27	0.92	166.49
683	7276	18852595	8/14/17	C	EXAR Stetson 3704B	65	12	-0.1	53	28	97	27	0.56	0.63	96.29
685	7287B	18845790	8/2/17	B	HA Cowboy Up 5405	63	6	1.9	65	21	119	53	0.22	0.55	149.21
687	7260	18848971	8/7/17	C	EXAR Stetson 3704B	69	8	1.3	51	20	91	24	0.42	0.49	86.93
689	7913B	18852488	8/13/17	B	3F Epic 4631	73	12	0.8	74	21	136	65	0.50	0.62	165.98
693	7904B	18851347	8/8/17	B	3F Epic 4631	72	11	0.0	69	20	128	48	0.57	0.45	142.41
694	7908B	18851351	8/10/17	B	EXAR Stetson 3704B	49	9	1.0	56	25	96	26	0.43	0.60	91.65
696	7277	18853607	8/16/17	C	HA Cowboy Up 5405	67	6	2.2	72	19	127	55	0.35	0.49	160.35
701	7278B	18845785	8/2/17	B	EXAR Stetson 3704B	81	8	1.9	60	26	104	36	0.35	0.68	115.94
702	7254	18845770	7/31/17	C	G A R Prophet K243	68	8	2.0	62	28	111	38	0.93	0.68	123.09
713	7242	18848285	7/16/17	C	EXAR Avatar 5516B	69	4	2.2	56	23	106	42	0.46	0.54	137.45
728	7290B	18845792	8/3/17	B	HA Cowboy Up 5405	80	5	2.2	66	9	121	54	0.07	0.64	140.65



## *Upcoming EX Sales*

**Plan to join us for these events.**

<b>OCTOBER 2, 2017</b> ... EX Fall Bull Sale	<b>MARCH 2018</b> ... EX Honor Roll Sale March
<b>OCTOBER 15, 2017</b> ... EX Hereford Event	<b>MARCH 2018</b> ... EX New Mexico Bull Sale, Newkirk, NM
<b>MARCH 2018</b> ... EX Spring Bull Sale	<b>APRIL 2018</b> ... EX Grass Time Sale





405.350.0044

www.expressranches.com

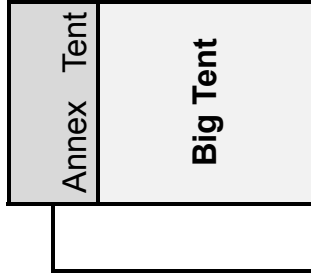
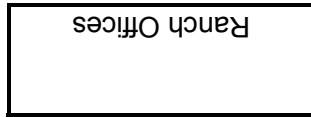
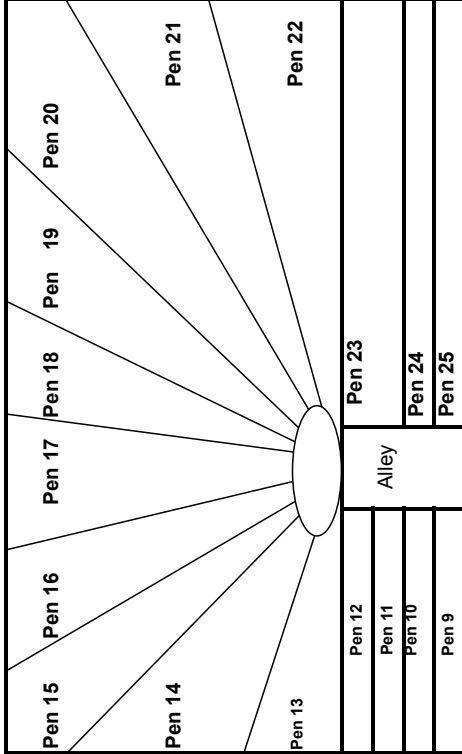

Main Entrance

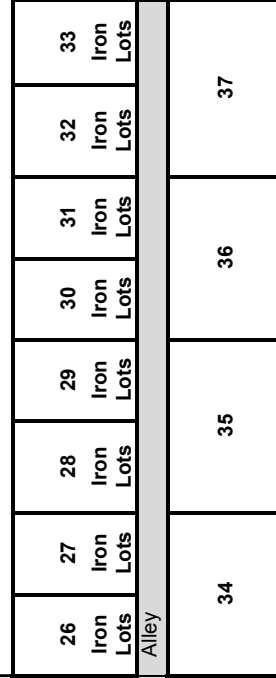
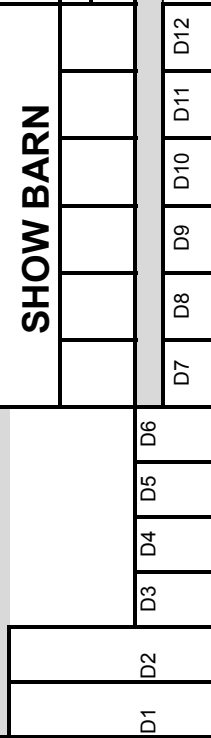

Legend

- ANX = Annex Tent
- BGT = Big Tent
- PVT = Pivot Pen
- SB = Show Barn

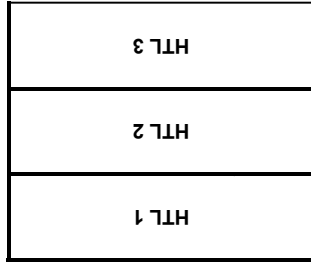

— SALE ORDER —

FRIDAY, AUGUST 18 • SELL IN NUMERICAL ORDER • LOTS 501-731

SATURDAY, AUGUST 19 • SALE ORDER BELOW

LOT	LOCATION	LOT	LOCATION	LOT	LOCATION	LOT	LOCATION	LOT	LOCATION
1	TENT	225A	TENT	100	SHOW BARN	117	D10	98	TENT
1A	PREG	225B	TENT	105	SHOW BARN	118	D10	27	TENT
2	TENT	64	ANNEX	123	SHOW BARN	119	D10	28	TENT
13	D5	51	ANNEX	127	SHOW BARN	120	D10	34	TENT
14	D5	208	ANNEX	151	SHOW BARN	216	RUN 2	41	TENT
16	D5	210A	ANNEX	115	SHOW BARN	217	RUN 2	25A	RUN 8
15	D5	210B	ANNEX	126	SHOW BARN	218	RUN 2	25B	RUN 8
212	D4	206	ANNEX	113	SHOW BARN	219	RUN 2	30	RUN 8
209	D4	205	ANNEX	114	SHOW BARN	220	RUN 2	31	RUN 8
12A	TENT	213	ANNEX	121	SHOW BARN	221	RUN 2	94	RUN 8
12B	TENT	55A	ANNEX	104	SHOW BARN	222	RUN 2	95	RUN 8
47	D4	55B	ANNEX	116	SHOW BARN	223	RUN 2	96	RUN 8
11	D4	56A	ANNEX	107	SHOW BARN	224	RUN 2	97	RUN 8
4B	D4	56B	ANNEX	110	SHOW BARN	227	RUN 3	99A	RUN 8
5	D4	4A	ANNEX	101	SHOW BARN	228	RUN 3	99B	RUN 8
10A	TENT	4C	ANNEX	137	SHOW BARN	229	RUN 3	211A	RUN 8
10B	TENT	8B	ANNEX	139	SHOW BARN	230	RUN 3	211B	RUN 8
10C	TENT	40A	RUN 1	152	SHOW BARN	231	RUN 3		
62	TENT	38A	RUN 1	150	SHOW BARN	232	RUN 3		
37	D3	38B	RUN 1	103	SHOW BARN	233	RUN 3		
36	D3	9	RUN 1	111	SHOW BARN	234	RUN 3		
35	D3	39	RUN 1	112	SHOW BARN	235	RUN 3		
29	D3	33A	RUN 1	133	SHOW BARN	53	RUN 5		
38	D3	33B	RUN 1	108	SHOW BARN	52	RUN 5		
18 & A	D2	26	RUN 1	129	SHOW BARN	57A	RUN 5		
19 & A	D2	40B	RUN 1	131	SHOW BARN	57B	RUN 5		
78 & A	D2	32A	RUN 1	122	SHOW BARN	50	RUN 5		
67 & A	D2	32B	RUN 1	132	SHOW BARN	59	RUN 5		
68	D2	32C	RUN 1	134	SHOW BARN	60	RUN 5		
75	D2	69 & A	D7	136	SHOW BARN	61	RUN 5		
74	D2	76 & A	D7	148	SHOW BARN	63A	RUN 5		
79	D2	80	D7	106	SHOW BARN	63B	RUN 5		
89 & A	D2	81 & A	D7	138	SHOW BARN	65	RUN 5		
90 & A	D2	82 & A	D7	146	SHOW BARN	66	RUN 5		
70	TENT	83 & A	D7	141	SHOW BARN	207	RUN 5		
3	TENT	84 & A	D7	142	SHOW BARN	214	RUN 5		
20A 20AA	PREG	86 & A	D8	130	SHOW BARN	236	RUN 6		
21	PREG	87 & A	D8	140	SHOW BARN	237	RUN 6		
6	TENT	88 & A	D8	144	SHOW BARN	238	RUN 6		
6A	PREG	77	D8	143	SHOW BARN	24	RUN 6		
6B	PREG	91	D8	145	SHOW BARN	239	RUN 6		
7	TENT	92 & A	D8	149	SHOW BARN	240	RUN 6		
8A	ANNEX	93 & A	D8	124	SHOW BARN	241	RUN 6		
17	D1	72	D9	135	SHOW BARN	242	RUN 6		
17A	D1	73	D9	147	SHOW BARN	243	RUN 6		
17B	D1	202	D9	102	SHOW BARN	244	RUN 6		
22	D1	203	D9	109	SHOW BARN	245	RUN 6		
22B	D1			125	SHOW BARN	246	RUN 7		
22C	D1			128	SHOW BARN	247	RUN 7		
22D	D1					248	RUN 7		
23	D1					249	RUN 7		
201	D1					250	RUN 7		
204	D1					251	RUN 7		
44	ANNEX					252A	RUN 7		
49	ANNEX					252B	RUN 7		
42	ANNEX					253	RUN 7		
45	ANNEX								
46	ANNEX								
48	ANNEX								
43	ANNEX								

LOTS 301 & 301A  
THRU  
358 & 358A  
SELL IN LOT ORDER  
(PENS 9-16)

